

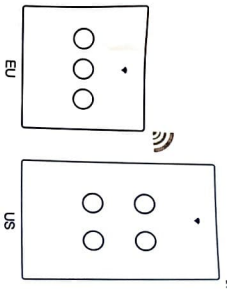

Smart Single Fire Wire Switch



Add Devices



Please scan the QR code or download Smart Life on App Store.

Registration or Log In

- Download "Smart Life Application"
- Enter the Register/Login information "Register" to create an account by entering your phone number to get verification code and "Set Password" Choose "Log In" if you already have a Smart Life account.

Configure the APP to the switch

- Preparation: Ensure the switch has been connected with Wi-Fi and is able to connect to the Internet.

Set your Echo speaker by Alexa APP

- 1 If you have finished installing Smart Life, just open Amazon Alexa App, log into your Alexa account with password.

- 2 Click the menu on the top left -> click "Settings" -> choose "Set up a new device" (click device like Echo)

NOTE

When below page appears, just press the small dot on your Echo device until the light turns to yellow, then click "Continue" on the App.
Attention: The mobile phone can not open a variety of VPN software.

- 3 Choose your own Wi-Fi and wait for a few minutes. After watching an introduction video, click "Next step", then it will enter home page automatically. Now the Echo has been connected to Wi-Fi successfully.

Enter Smart Life Skill In Alexa APP

- Choose "Skill" in the options bar, and then search "Smart Life" in the input box.

Product Description

The new designed glass panel wireless touch smart switch is designed with Wi-Fi, no need to replace traditional switches with a multi-control association. You can now smart switch feature as into the Smart Life/Tuya App, the smart switch is added on/off and relay status and its scratch with its light status. Note: Button sound on and off; no button operations before operations begin within 6 seconds. Then press switch button 3 times and long press for the fourth time until the switch beep sound as On-Off for 2 times for successful operation.

Safety Information

Risk of Electric Shock: Electricity can cause personal injury and property damage if handled improperly. Please read about any part of these instructions, please seek professional assistance from a qualified electrician.

Technical Parameters

- Model: WS-EU-FF / WS-US-FF
- Voltage: US: 120V AC, 60Hz / 200-240V AC, 50Hz
- Max. total power: 1500 AC total load 325W/3gang
- Max. total power: 240V AC total load 600W/3gang
- Frequency: 50/60Hz

Warnings

Turn off the power at the circuit breaker and test that power is Off before wiring.

Installation

NOTE

- Install the switch by electricity off.
- Do not install in damp environment.
- Neutral wire in not required (single line half).
- Please follow instructions and properly install.
- If you don't have any wiring experience, please call a professional electrician.

Step 1

- Turn off the circuit breaker and use the electrical tester to test the power.
- Ensure the switch is off before wiring.



Step 2

- Remove the panel with screwdriver (Please don't install with electricity power on)

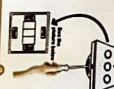

3 Select the device you want to add and click "Add"

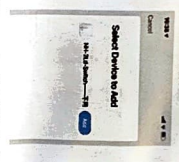

- Enter Wi-Fi Password and click "Confirm" waiting for completing the connection.



- 5 Add the device successfully, you can edit the name of the device to enter the device page by click "Done"

Step 3

- Prepare to install wiring
- Lamp wire connects "L" terminal
- 1 Gang wire connects "L1, L2, L3, L4" terminal
- Neutral wire in not required (single line half)
- 2 Gang connects "L1, L2, L3" terminal
- 3 Gang connects "L1, L2, L3, L4" terminal
- 4 Gang connects "L1, L2, L3, L4" terminal
- 4. Groundance installation

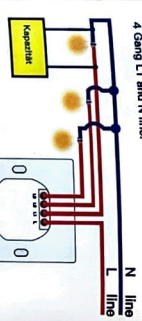

- Capabilities the as shown in the drawing:
- 1 Gang L1 and N line.
- 2 Gang L1 and N line.
- 3 Gang L1 and N line.
- 4 Gang L1 and N line.

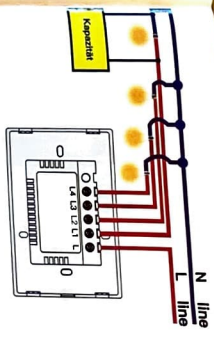

Step 4

- Put the switch into switch box in the wall
- Mount the two side screws
- Install the glass panel (install from up down)

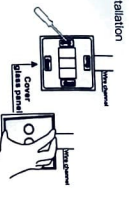

Finish installation

- Finish installation

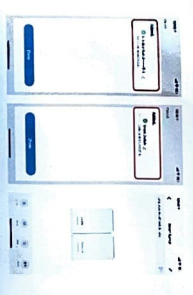

How to reset/repair Wi-Fi code

Press the switch button for 6 times and hold on the 6th time, then release until you hear Di-Di-Di3 times, and the blue indicator on the switch will flash fast after 3 seconds flash/rapid is successful.

Remote radio frequency (RF) link method:

- 1. How to pair the RF code
- 1.1 (can be turned on and off): Confirm your switch is off before operations. Press the switch button for about 6 seconds before operations. Press the switch button for about 6 seconds successful. The key of the remote controller can control the switching of the state of the switch on and off corresponding to the position of the switch.

WENZOU NOVIA NEW ENERGY CO. LTD.

Address: Power Science and Technology Innovation Center, NO.238, Wei 11 Road, Yueling Economic Development Zone, Yangling, Zhejiang, China
Tel: +86-577-57119815
Email: service@moeshouse.com

AUZLAB GmbH
Luisenpark 23, 45258 Essen
Made in China

Follow US

- Facebook: @moessmart
- Twitter: @moes_smart
- Instagram: @moes_smart
- YouTube: moes
- LinkedIn: @moes_smart
- Website: www.moeshouse.com
- Email: service@moeshouse.com

Thank you for your support and purchase at we Moes, we are always here for your complete satisfaction, just feel free to share your great shopping experience with us.

★★★★★

If you have any other need, please do not hesitate to contact us first, we will try to meet your demand.

1.2 (Open only) Confirm your switch is off before operations - Press the switch button for about 3 seconds the corresponding (ring) light will remote control to turn on. Then the matching of RF codes is successful. The key of the remote controller can control the corresponding position of the switch to be open.

- 1.3 (Close only): Confirm your switch is on before operations. Press the switch button for about 5 seconds until you hear Di (ring) After that, release the button, press the corresponding button on the remote control to turn on. Then the matching of RF codes is successful. The key of the remote controller can control the corresponding position of the switch to be closed.

2 How to clear up the RF code

Confirm your switch is off before operations. Press the switch button for a long time until you hear Di-Di-Di-Di4 times, and then release the button. The RF code is now cleared up.

How to achieve multi-control association

- 1. Multiple above for adding the switch to your Smart Life App before the association.
- 1.1 WiFi add another smart switch to the same Smart Life/Tuya App. If there is a smart switch having been added before to the app, just go to next step. Note: there is no need to wire the added switch to the light. L1 and N are required for wiring.
- 1.2 After the new smart switch app is added, you can connect switches (One gang switch as below) by entering into the next operation.